



Bomba Centrífugas Monobloco

Linha: Mega

Versão: Bloc

1. Aplicações

A bomba Megabloc é indicada para bombeamento de líquidos limpos ou turvos e encontra aplicação preferencial em:

- Abastecimento em geral
- Irrigação
- Circulação de condensados
- Instalações prediais
- Ar condicionado
- Serviços de refrigeração
- Indústrias em geral

2. Descrição Geral

Bomba centrífuga horizontal, simples estágio, sucção horizontal e descarga vertical, acoplada ao motor elétrico no sistema monobloco.

3. Denominação

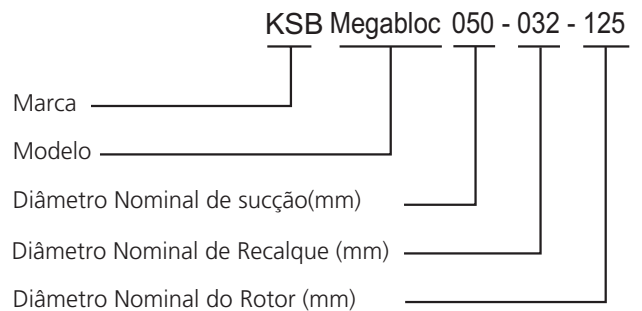

4. Dados de Operação

Tamanhos	• DN 32 até 150
Vazões	• até 550 m ³ /h
Elevações	• até 140 m
Temperatura de operação	• até 90 °C
Pressão de sucção máxima	• 3 bar
Pressão de descarga máxima	• 13 bar
Rotações	• até 3.500 rpm



PRODUTOS COM SELO PROCEL (*)

- ✓ Alta Tecnologia
- ✓ Maior Eficiência
- ✓ Menor consumo de Energia Elétrica

* Consulte a fábrica para saber os tamanhos que possuem o selo.

6. Tabela de Seleção Megabloc IV Polos - 1.750RPM - 60Hz

Modelo de Bomba	CV	Diâmetro Rotor (mm)	Altura Manométrica (em mca)																							Altura máxima
			02	03	04	05	06	07	08	09	10	11	12	13	14	15	16	17	18	19	20	21	22	23		
			Vazão (em m³/h)																							
050-032-200	1,5	180								18,5	18,0	17,5	15,5	14,0	12,0										15,0	
050-032-200	2,0	193										21,0	20,0	19,0	17,5	16,0	14,0	10,0							18,5	
050-032-200	3,0	206													23,0	22,0	20,5	19,0	17,5	15,0					21,0	
050-032-200	3,0	209														24,0	23,0	22,0	21,0	19,0	17,0	15,0			22,0	
050-032-200.1	1,0	168							13,0	12,5	11,0	10,0	8,0	6,0											13,5	
050-032-200.1	1,0	180									14,5	13,5	12,0	11,0	9,0	7,0									16,0	
050-032-200.1	1,5	193										16,5	15,5	14,5	13,5	12,0	10,0	8,0							18,0	
050-032-200.1	2,0	204												18,0	16,5	15,5	14,5	13,0	11,5	10,0	8,0				21,0	
050-032-250	3,0	220															17,0	16,5	16,0	15,0	14,0	13,0			24,0	
050-032-250	3,0	232																	19,0	18,2	17,5	17,0	16,0		27,5	
050-032-250	4,0	246																				21,0	20,5	20,0	31,0	
050-032-250.1	2,0	210													10,5	10,0	9,5	9,0	8,0	7,0	6,0			21,0		
050-032-250.1	2,0	220														12,0	11,5	10,5	10,0	9,5	8,5	7,5	6,5		23,0	
050-032-250.1	3,0	232															13,0	12,5	11,5	11,0	10,5	10,0	9,0		26,0	
050-032-250.1	3,0	246																		14,5	14,0	13,5	13,0	12,5	30,0	
065-040-160	1,0	135				36,0	30,0	24,0	16,0																8,5	
065-040-160	1,5	148					36,0	30,0	24,0	17,0															10,5	
065-040-160	2,0	162					41,0	37,0	32,0	27,0	21,0														13,0	
065-040-160	2,0	174							42,0	37,0	33,0	28,0	23,0												15,0	
065-040-200	1,5	165						26,0	24,0	21,0	18,0														13,0	
065-040-200	2,0	173							28,0	26,0	23,0	20,0	15,0												14,5	
065-040-200	2,0	182								29,5	28,0	25,0	23,0	20,0											16,0	
065-040-200	3,0	192									32,0	30,0	28,0	26,0	23,0	20,0									18,0	
065-040-200	3,0	202										35,0	33,0	31,0	29,0	27,0	25,0	20,0							20,0	
065-040-200	3,0	209												37,0	35,0	33,0	31,0	29,0	29,0	26,0	23,0				22,0	
065-040-250	4,0	220												32,0	31,0	30,0	29,0	28,0	27,0	25,0	22,0	20,0	16,0		24,0	
065-040-250	5,0	235															36,0	34,5	34,0	32,5	32,0	30,0	28,0		28,0	
065-040-250	6,0	252																			40,0	39,5	38,5	37,0	32,5	
080-050-125	1,0	114	56,0	52,0	44,0	32,0																			6,0	
080-050-125	1,5	120		58,0	52,0	42,0	30,0																		6,5	
080-050-125	1,5	130			62,0	55,0	46,0	32,0																	8,0	
080-050-125	2,0	142			72,0	65,0	62,0	52,0	40,0	22,0															9,5	
080-050-160	1,5	135				50,0	44,0	34,0																	9,5	
080-050-160	2,0	150					56,0	49,0	40,0	26,0															11,5	
080-050-160	3,0	162						66,0	60,0	51,0	42,0	30,0													13,5	
080-050-160	4,0	174							70,0	62,0	54,0	46,0	30,0												15,5	
080-050-200	3,0	180							50,0	48,0	44,0	40,0	34,0												16,0	
080-050-200	4,0	193									56,0	53,0	50,0	45,0	40,0	34,0									19,0	
080-050-200	5,0	206												61,0	58,0	56,0	52,0	48,0	44,0	36,0					22,0	
080-050-200	6,0	219															54,0	52,0	49,0	46,0	42,0	37,0	32,0	26,0	25,0	
080-050-250	5,0	220																							24,0	
080-050-250	6,0	232																			56,0	54,0	50,0	46,0	42,0	27,5
100-065-125	1,0	123/106/100		60,0	40,0																				4,5	
100-065-125	1,5	126/112/100		65,0	50,0																				4,8	
100-065-125	1,5	126/120		78,0	67,0	50,0																			5,8	
100-065-125	2,0	136/129			84,0	73,0	60,0																		7,0	
100-065-125	3,0	141				90,0	78,0	65,0																	9,0	
100-065-160	1,5	132				63,0	55,0	40,0																	7,5	
100-065-160	3,0	145					75,0	65,0	55,0	40,0															9,5	
100-065-160	3,0	159						80,0	70,0	60,0	40,0														11,5	
100-065-160	4,0	174							90,0	83,0	73,0	60,0													14,0	
100-065-200	4,0	180								75,0	68,0	62,0	55,0	45,0											16,0	
100-065-200	5,0	193										80,0	75,0				60,0	53,0	40,0						18,5	
100-065-200	6,0	206												86,0	82,0		76,0	70,0	65,0	53,0	40,0				21,5	
100-065-200	7,5	219															97,0	93,0	87,0	81,0	75,0	70,0			24,0	
100-065-250	6,0	215															70,0	68,0	63,0	60,0	55,0	50,0			23,0	
100-065-250	10,0	232																							27,0	
125-080-160	4,0	153/138/135				140,0	120,0	100,0	70,0																9,0	
125-080-160	5,0	155/149					150,0	130,0	110,0	85,0	60,0														10,5	
125-080-160	5,0	162						160,0	140,0	120,0	100,0	78,0													12,0	
125-080-160	7,5	174							162,0	150,0	130,0	110,0	85,0												14,0	
125-080-200	6,0	180									125,0	115,0	105,0	90,0	70,0										16,0	
125-080-200	7,5	190										125,0	115,0	100,0	90,0	60,0									18,0	
125-080-200	10,0	198											143,0	135,0	125,0	117,0	105,0	90,0	70,0						20,0	
125-080-200	10,0	208													150,0	142,0	135,0	125,0	115,0	100,0	75,0				22,0	
125-080-200	12,5	219															155,0	147,0	140,0	125,0	120,0	105,0			24,0	
125-080-250	10,0	215															125,0	120,0	110,0	103,0	95,0	85,0	70,0		23,5	
125-080-250	10,0	223																125,0	120,0	112,0	105,0	95,0			25,5	
125-080-250	12,5	231																	135,0	130,0	120,0	115,0			27,0	
125-100-200	10,0	180									195,0	180,0	160,0	140,0	125,0	100,0									15,5	
125-100-200	12,5	193											210,0	200,0	180,0	170,0	150,0	120,0							17,5	

- Bocais Flangeados norma ANSI B16.1 125#FF, diâmetros, consulte tabela de medidas.
 - Tamanhos maiores, sob consulta.

6. Tabela de Seleção Megabloc IV Polos - 1.750RPM - 60Hz - Continuação

Modelo de Bomba	CV	Diâmetro Rotor (mm)	Altura Manométrica (em mca)																						Altura máxima
			24	25	26	27	28	29	30	31	32	33	34	35	36	37	38	39	40	41	42	43	44	45	
			Vazão (em m³/h)																						
050-032-250	3,0	232	15,0	14,0	12,0	10,0																		27,5	
050-032-250	4,0	246	19,5	18,5	18,0	17,0	16,0	15,0	13,0															31,0	
050-032-250	5,0	261			22,5	21,5	21,0	20,5	20,0	19,0	18,0	16,5	15,0	12,0										36,0	
050-032-250.1	3,0	232	8,0	7,0																				26,0	
050-032-250.1	3,0	246	12,0	11,0	10,5	9,5	8,5	7,5																30,0	
050-032-250.1	3,0	254	13,5	12,5	12,0	11,5	10,5	10,0	9,0	7,5														32,0	
065-040-250	5,0	235	26,0	24,0	22,0	17,0																		28,0	
065-040-250	6,0	252	36,0	35,0	34,0	32,0	30,0	28,0	24,0	20,0														32,5	
065-040-250	6,0	260	40,0	39,0	38,0	36,0	35,0	33,0	31,5	29,0	26,0	22,0												34,0	
080-050-250	6,0	232	38,0	34,0	28,0																			27,5	
080-050-250	7,5	246	54,0	50,0	47,0	44,0	40,0	34,0	28,0															31,0	
080-050-250	10,0	260	66,0	64,0	62,0	58,0	56,0	52,0	49,0	44,0	40,0	34,0	20,0											35,0	
080-050-315	10,0	270			62,0	60,0	58,0	55,0	52,0	50,0	47,0	45,0	40,0	35,0										36,5	
080-050-315	12,5	285				70,0	68,0	67,0	65,0	63,0	62,0	60,0	58,0	55,0	52,0	50,0	45,0	40,0	30,0					41,0	
100-065-250	10,0	232	65,0	60,0	55,0																			27,0	
100-065-250	10,0	246	85,0	83,0	77,0	75,0	70,0	65,0																30,0	
100-065-250	12,5	260		100,0	95,0	92,0	87,0	85,0	80,0	77,0	70,0	60,0												34,0	
100-065-315	12,5	270	100,0	98,0	95,0	93,0	90,0	85,0	80,0	78,0	73,0	67,0	60,0											35,0	
125-080-250	12,5	231	100,0	90,0	75,0																			27,0	

- Bocais Flangeados norma ANSI B16.1 125#FF, diâmetros, consulte tabela de medidas.

- Tamanhos maiores, sob consulta.

7. Tabela de Medidas - II Polos - 3.500 rpm - 60Hz

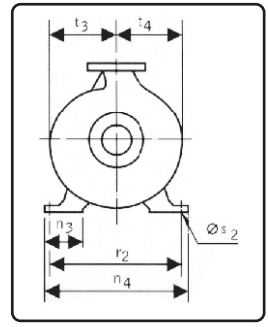
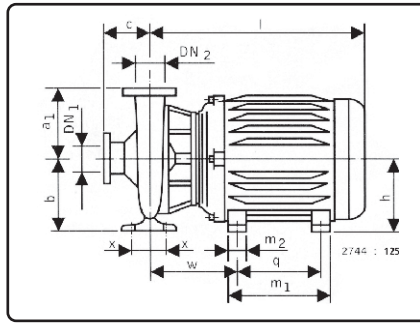
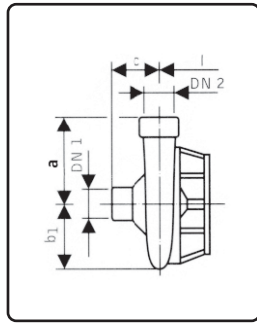
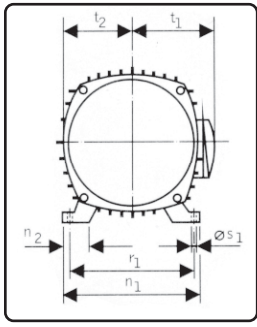

Tamanho	Flanges (1)		Carcaça Motor	Potência Motor (cv)	Peso (Kg)	Dimensões aproximadas dos conjuntos em milímetros																						
	DN1	DN2				h1	h2	h3	a	h	m3	m4	n5	n4	q	r1	s2	t1	t2	n1	n2	n3	m1	m2	s1	b	w	l
040-025-160	1.1/2	1	90S	1,5	40	132	160	100	80	90	131	n.a	164	36,5	100	140	10	159	89,5	240	190	140	100	70	14	50	174	374
			90S	2	41					90	131	n.a	164	36,5	100	140	10	159	89,5								174	374
			90S	3	44					90	131	n.a	164	36,5	100	140	10	159	89,5								174	374
			90L	4	45					90	156	n.a	164	36,5	125	140	10	159	89,5								174	399
			100L	5	54					100	173	n.a	188	40	140	160	12	169	99,5								171	425
040-025-200	1.1/2	1"	90S	3	50	160	180	125	80	90	131	n.a	164	36,5	100	140	10	159	89,5	240	190	140	100	70	14	50	174	374
			90L	4	51					90	156	n.a	164	36,5	125	140	10	159	89,5								174	399
			100L	5	60					100	173	n.a	164	40	140	160	12	169	99,5								171	425
			112M	6	68					112	177	n.a	220	40,5	140	190	12	192	111								178	442
			132S	10	96					132	187	n.a	248	45	140	216	12	220	136								197	481
050-032-125	2"	1.1/4"	90S	2	39	112	140	100	80	90	131	n.a	164	36,5	100	140	10	159	89,5	190	140	90	100	70	14	50	174	374
			90S	3	42					90	131	n.a	164	36,5	100	140	10	159	89,5								174	374
			90L	4	43					90	156	n.a	164	36,5	125	140	10	159	89,5								174	399
			100L	5	52					100	173	n.a	188	40	140	160	12	169	99,5								171	425
			112M	6	60					112	177	n.a	220	40,5	140	190	12	192	111								178	442
050-032-125.1	2"	1.1/4"	90S	1,5	39	112	140	100	80	90	131	n.a	164	36,5	100	140	10	159	89,5	190	140	90	100	70	14	50	174	374
			90S	2	40					90	131	n.a	164	36,5	100	140	10	159	89,5								174	374
			90L	3	43					90	156	n.a	164	36,5	125	140	10	159	89,5								174	399
			100L	4	44					100	173	n.a	188	40	140	160	12	169	99,5								171	425
			112M	5	53					112	177	n.a	220	40,5	140	190	12	192	111								178	442
050-032-160	2"	1.1/4"	90L	4	44	132	160	115	80	90	156	n.a	164	36,5	125	140	10	159	89,5	240	190	140	100	70	14	50	174	399
			100L	5	53					100	173	n.a	188	40	140	160	12	169	99,5								171	425
			112M	6	62					112	177	n.a	220	40,5	140	190	12	192	111								178	442
			132S	10	89					132	187	n.a	248	45	140	216	12	220	136								197	481
			132M	12,5	96					132	225	n.a	248	45	178	216	12	220	136								197	519
050-032-160.1	2"	1.1/4"	90L	4	45	132	160	110	80	90	156	n.a	164	36,5	125	140	10	159	89,5	240	190	140	100	70	14	50	174	399
			100L	5	54					100	173	n.a	188	40	140	160	12	169	99,5								171	425
			112M	6	62					112	177	n.a	220	40,5	140	190	12	192	111								178	442
			112M	7,5	65					112	177	n.a	220	40,5	140	190	12	192	111								178	442
			132S	10	95					132	187	n.a	248	45	140	216	12	220	136								197	481
050-032-200	2"	1.1/4"	132M	12,5	102	160	180	125	80	132	225	n.a	248	45	178	216	12	220	136	240	190	140	100	70	14	50	178	442
			112M	7,5	69					112	177	n.a	220	40,5	140	190	12	192	111								178	442
			132S	10	94					132	187	n.a	248	45	140	216	12	220	136								197	481
			132M	12,5	101					132	225	n.a	248	45	178	216	12	220	136								197	519
			90L	4	45					90	156	n.a	164	36,5	125	140	10	159	89,5								174	399
050-032-250.1	2"	1.1/4"	132M	12,5	116	180	225	N.A.	100	132	225	n.a	248	45	178	216	12	220	136	320	250	190	125	95	14	65	174	519
			90L	4	46					90	156	n.a	164	36,5	125	140	10	159	89,5								174	399
			100L	5	55					100	173	n.a	188	40	140	160	12	169	99,5								171	425
			112M	7,5	66					112	177	n.a	220	40,5	140	190	12	192	111								178	442
			132S	10	91					132	187	n.a	248	45	140	216	12	220	136								197	481
065-040-125	2.1/2	1.1/2	112M	7,5	68	112	140	100	80	112	177	n.a	220	40,5	140	190	12	192	111	210	160	110	100	70	14	50	178	442
			132S	10	91					132	187	n.a	248	45	140	216	12	220	136								197	481
			112M	7,5	68					112	177	n.a	220	40,5	140	190	12	192	111								178	442
			132S	10	92					132	187	n.a	248	45	140	216	12	220	136								197	481
			132M	12,5	99					132	225	n.a	248	45	178	216	12	220	136								197	519
065-040-160	2.1/2	1.1/2	112M	7,5	70	132	160	120	80	112	177	n.a	187	40,5	140	190	12	192	111	240	190	140	100	70	14	50	178	442
			132S	10	94					132	187	n.a	248	45	140	216	12	220	136								197	481
			132M	12,5	100					132	187	n.a	248	45	140	216	12	220	136								197	481
			112M	7,5	70					112	177	n.a	187	40,5	140	190	12	192	111								178	442
			132M	12,5	101					132	225	n.a	240	45	140	216	12	220	136								197	481
065-040-200	2.1/2	1.1/2	132M	12,5	101	160	180	140	100	132	225	n.a	248	45	178	216	12	220	136	240	190	140	100	70	14	50	178	442
			112M	7,5	70					112	177	n.a	187	40,5	140	190	12	192	111								178	442
			132S	10	94					132	187	n.a	248	45	140	216	12	220	136								197	481
			132M	12,5	101					132	225	n.a	248	45	178	216	12	220	136								197	519
			90L	4	46					90	156	n.a	164	36,5	125	140	10	159	89,5								174	399
080-050-125	3	2	132M	12,5	103	132	160	110	100	132	225	n.a	240	45	140	216	12	220	136	240	190	140	100	70	14	50	197	481
			112M	7,5	79					112	177	n.a	220	40,5	140	190	12	192	111								178	442
			132S	10	103					132	187	n.a	248	45	140	216	12	220	136								197	481
			112M	7,5	79					112	177	n.a	220	40,5	140	190	12	192	111								178	442
			132S	10	103					132	187	n.a	248	45	140	216	12	220	136								197	481
100-065-125	4	2.1/2	132M	12,5	119	160	200	140	100	132	225	n.a	248	45	178	216	12	220	136	280	212	150	125	95	14	65	178	442
			112M	7,5	79					112	177	n.a	220	40,5	140	190	12	192	111								178	442
			132S	10	103					132	187	n.a	248	45	140	216	12	220	136								197	481
			112M	7,5	79					112	177	n.a	220	40,5	140	190	12	192	111								178	442
			132S	10	103					132	187	n.a	248	45	140	216	12	220	136								197	481

(1) As conexões de sucção e descarga de bombas até o tamanho 100-065-200, podem ser rosqueadas ou flangeadas conforme rosca BSP ou Flange norma ANSI B16.1 125#FF, exceto os tamanhos 050-032-250.1, 050-032-250 e 065-040-250 que são fornecidos somente flangeados conforme ANSI B16.1 125#FF.

Valores orientativos com base em motor elétrico classe de eficiência IE 2, podendo variar conforme marca do motor empregado.

Pesos informados com base na execução flangeada.

8. Tabela de Medidas - VI Polos - 1.750 rpm - 60Hz

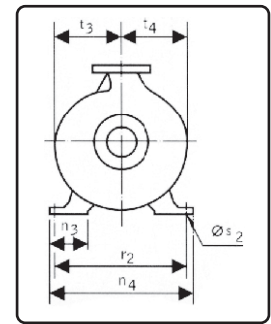
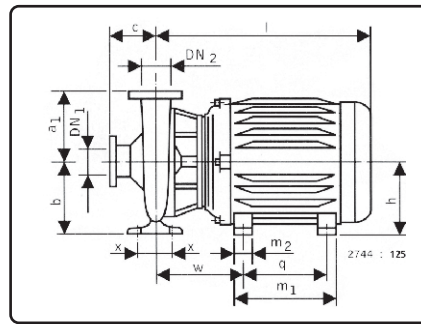
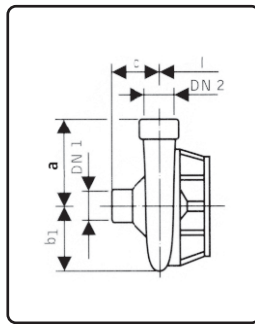
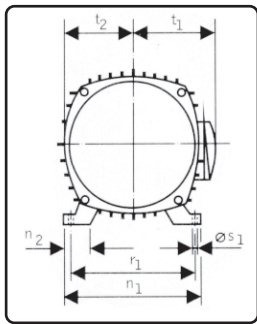

Tamanho	Flanges (1)		Carcaça Motor	Potência Motor (cv)	Peso (Kg)	Dimensões aproximadas dos conjuntos em milímetros																					
	DN1	DN2				h1	h2	a	h	m3	m4	n5	n4	q	r1	s2	t1	t2	n1	n2	n3	m1	m2	s1	b	w	l
050-032-200	2	1.1/4	90S	1,5	48	160	180	80	90	131	n.a	164	36,5	100	140	10	159	89,5	240	190	140	100	70	14	50	174	374
			90S	2	49				90	131	n.a	164	36,5	100	140	10	159	89,5								174	374
			90L	3	51				90	156	n.a	164	36,5	125	140	10	159	89,5								174	399
050-032-200.1	2	1.1/4	90S	1	45	160	180	80	90	131	n.a	164	36,5	100	140	10	159	89,5	240	190	140	100	70	14	50	174	374
			90S	1,5	48				90	131	n.a	164	36,5	100	140	10	159	89,5								174	374
			90L	3	66				90	156	n.a	164	36,5	125	140	10	159	89,5								174	399
050-032-250 (1)	2"	1.1/4"	100L	4	74	180	225	100	100	173	n.a	188	40	140	160	12	169	99,5	320	250	190	125	95	14	65	171	425
			100L	5	79				100	173	n.a	188	40	140	160	12	169	99,5								171	425
			90S	2	64				90	131	n.a	164	36,5	100	140	10	159	89,5								174	374
050-032-250.1 (1)	2"	1.1/4"	90L	3	66	180	225	100	90	156	n.a	164	36,5	125	140	10	159	89,5	320	250	190	125	95	14	65	174	399
			90S	1	43				90	131	n.a	164	36,5	100	140	10	159	89,5								174	374
			90S	1,5	46				90	131	n.a	164	36,5	100	140	10	159	89,5								174	374
065-040-160 (1)	2.1/2	1.1/2	90S	1,5	46	132	160	80	90	131	n.a	164	36,5	100	140	10	159	89,5	240	190	140	100	70	14	50	174	374
			90S	2	47				90	131	n.a	164	36,5	100	140	10	159	89,5								174	374
			90L	3	49				90	156	n.a	164	36,5	125	140	10	159	89,5								174	399
065-040-200	2.1/2	1.1/2	90S	1,5	53	160	180	100	90	131	n.a	164	36,5	100	140	10	159	89,5	265	212	165	100	70	14	50	174	374
			90S	2	54				90	131	n.a	164	36,5	100	140	10	159	89,5								174	374
			90L	3	56				90	156	n.a	164	36,5	125	140	10	159	89,5								174	399
065-040-250 (1)	2.1/2	1.1/2	100L	4	64	180	225	100	100	173	n.a	188	40	140	160	12	169	99,5	320	250	190	125	95	14	65	171	425
			90L	3	68				90	156	n.a	164	36,5	125	140	10	159	89,5								174	399
			100L	4	76				100	173	n.a	188	40	140	160	12	169	99,5								171	425
080-050-125	3	2"	100L	5	81	132	160	100	100	173	n.a	188	40	140	160	12	169	99,5	240	190	140	100	70	14	50	171	425
			112M	6	87				112	177	n.a	220	40,5	140	190	12	192	111								178	442
			90S	1	46				90	131	n.a	164	36,5	100	140	10	159	89,5								174	374
080-050-160	3	2"	90S	1,5	49	160	180	100	90	131	n.a	164	36,5	100	140	10	159	89,5	265	212	165	100	70	14	50	174	374
			90S	2	50				90	131	n.a	164	36,5	100	140	10	159	89,5								174	374
			90S	1,5	50				90	131	n.a	164	36,5	100	140	10	159	89,5								174	374
080-050-200	3	2	90S	2	51	160	180	100	90	131	n.a	164	36,5	100	140	10	159	89,5	265	212	165	100	70	14	50	174	374
			90L	3	53				90	156	n.a	164	36,5	125	140	10	159	89,5								174	399
			100L	4	61				100	173	n.a	188	40	140	160	12	169	99,5								171	425
080-050-250 (1)	3	2	90L	3	59	160	200	100	90	156	n.a	164	36,5	125	140	10	159	89,5	265	212	165	100	70	14	50	174	399
			100L	4	67				100	173	n.a	188	40	140	160	12	169	99,5								171	425
			100L	5	72				100	173	n.a	188	40	140	160	12	169	99,5								171	425
080-050-250 (1)	3	2	112M	6	78	180	225	125	112	177	n.a	220	40,5	140	190	12	192	111	320	250	190	125	95	14	65	178	442
			100L	5	84				100	173	n.a	188	40	140	160	12	169	99,5								171	425
			112M	6	90				112	177	n.a	220	40,5	140	190	12	192	111								178	442
080-050-250 (1)	3	2	132S	7,5	115	225	280	125	132	187	n.a	248	45	140	216	12	220	136	345	280	215	125	95	14	65	197	481
			132S	10	120				132	187	n.a	248	45	140	216	12	220	136								197	481
			132M	12,5	147				132	225	n.a	248	45	178	216	12	220	136								197	519
100-065-125	4	2.1/2	90S	1,5	58	160	180	100	90	131	n.a	164	36,5	100	140	10	159	89,5	280	212	150	125	95	14	65	174	374
			90S	2	59				90	131	n.a	164	36,5	100	140	10	159	89,5								174	374
			90M	3	61				90	156	n.a	164	36,5	125	140	10	159	89,5								174	399
100-065-160	4	2.1/2	90S	1,5	66	160	200	100	90	131	n.a	164	36,5	100	140	10	159	89,5	280	212	150	125	95	14	65	174	374
			90S	2	67				90	131	n.a	164	36,5	100	140	10	159	89,5								174	374
			90L	3	69				90	156	n.a	164	36,5	125	140	10	159	89,5								174	399
100-065-200	4	2.1/2	100L	4	77	180	225	100	100	173	n.a	188	40	140	160	12	169	99,5	320	250	190	125	95	14	65	171	425
			100L	4	73				100	173	n.a	188	40	140	160	12	169	99,5								171	425
			100L	5	78				100	173	n.a	188	40	140	160	12	169	99,5								171	425
100-065-250 (1)	4	2.1/2	112M	6	84	200	250	125	112	177	n.a	220	40,5	140	190	12	192	111	360	280	200	160	120	18	80	178	442
			132S	7,5	108				132	187	n.a	248	45	140	216	12	220	136								197	481
			132S	10	113				132	187	n.a	248	45	140	216	12	220	136								197	481
100-065-315	4	2.1/2	112M	6	106	225	280	125	112	177	n.a	220	40,5	140	190	12	192	111	400	315	240	160	120	18	80	197	519
			132S	7,5	129				132	187	n.a	248	45	178	216	12	220	136								197	519
			132M	12,5	140				132	225	n.a	248	45	178	216	12	220	136								197	519
125-080-160	5	3	100L	4	85	180	225	125	100	173	n.a	188	40	140	160	12	169	99,5	320	250	190	125	95	14	65	171	425
			100L	5	90				100	173	n.a	188	40	140	160	12	169	99,5								171	425
			112M	6	96				112	177	n.a	220	40,5	140	190	12	192	111								178	442
125-080-200	5	3	132S	7,5	119	180	250	125	132	187	n.a	248	45	140	216	12	220	136	345	280	215	125	95	14	65	197	481
			112M	6	99				112	177	n.a	220	40,5	140	190	12	192	111								178	442
			132S	7,5	122				132	187	n.a	248	45	140	216	12	220	136								197	481
125-080-250 (1)	5	3	132M	12,5	133	225	280	125	132	225	n.a	248	45	178	216	12	220	136	400	315	240	160	120	18			